

WIREFATH

FIBER

I. Cleaver Wheel Height Adjustment instructions

The cleaver in the WP-TOOLKIT-FIBER-BAS/PRO termination kit comes pre-adjusted to cleave Wirepath SSF™ fiber. Height adjustment sets the wheel in the cleaver to correctly score the outer covering of the glass while the fiber is tensioned across two pads, providing a clean break for maximum signal transfer. Adjustments are made in fine increments until a successful cleave is achieved and takes five to ten minutes to perform.

If your cleaver will not successfully cleave SSF fiber, perform the Blade UP adjustment. For standard fiber, perform the Blade DOWN adjustment until the fiber is not cleaved, then perform the Blade UP adjustment until the fiber is successfully cleaved. Note: Instructions are the same for all cleaver models.

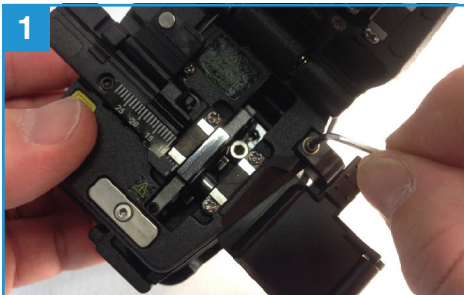

1 Use the included hex wrench to remove the fiber scrap box. Set the scrap box aside.



2 Use the hex wrench to remove the two screws that secure the guide cover. Set the cover aside.

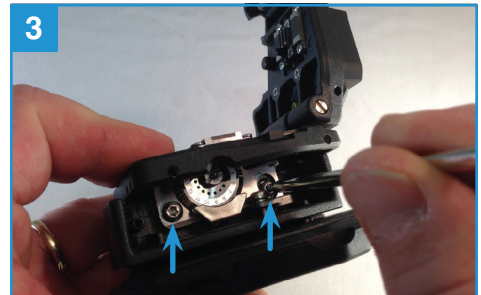

3 Use the included hex wrench to loosen the two guide setscrews about one turn. Do not loosen completely!



4 Look down into the top of the cleaver and loosen the blade height setscrew one turn. See cleaver manual for location.

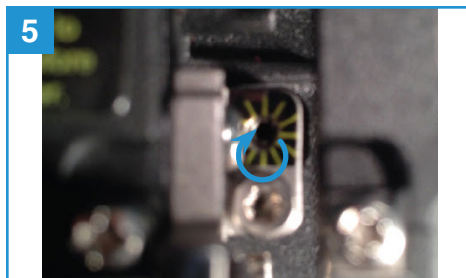

5 UP adjustment: Turn the height adjust screw clockwise (↻) 1/4 turn (2 marks), then tighten the blade height setscrew.



6 DOWN adjustment: Turn the height adjust screw counterclockwise (↻) 1/4 turn (2 marks), then tighten the blade height setscrew.



7 Tighten the two guide setscrews. Test the cleaver and repeat the adjustment steps until the fiber is cleanly cleaved.



8 After adjustments are complete, reattach the guide cover and the fiber scrap box. Adjustment is complete!