

Sunnata Dimmer MyLevel Personalization

Sunnata Models

[en español / en français](#)

ST-PRO-N	Sunnata PRO Dimmer	STCL-153P	Sunnata LED+ Dimmer
RRST-PRO-N	Sunnata RF Dimmer	STCL-153M	Sunnata LED+ Dimmer
HRST-PRO-N	Sunnata RF Dimmer		

Overview

MyLevel personalization gives you the ability to customize your Sunnata touch dimmer. From the main dimmer, you can adjust the brightness of the light bar as well as set a favorite level using the Feature menu. Before adjusting these features, it is important to have a good understanding of the advanced features. MyLevel personalization cannot be entered from a companion dimmer. Companion dimmers will match the settings of the main dimmer.

Identify your main dimmer:

Pull the FASS (Front Accessible Service Switch) out and push it back in. If the light bar blinks, this is your main dimmer. If not, go to your next location in your installation and repeat until you locate your main dimmer.

Easily adjust your dimmer in 5 steps:

1. Enter Feature menu
2. Select the feature you want to change
3. Change the feature
4. Save the setting
5. Exit

For instructional videos on how to adjust features, visit www.lutron.com/sunnatasupport

Dimmer

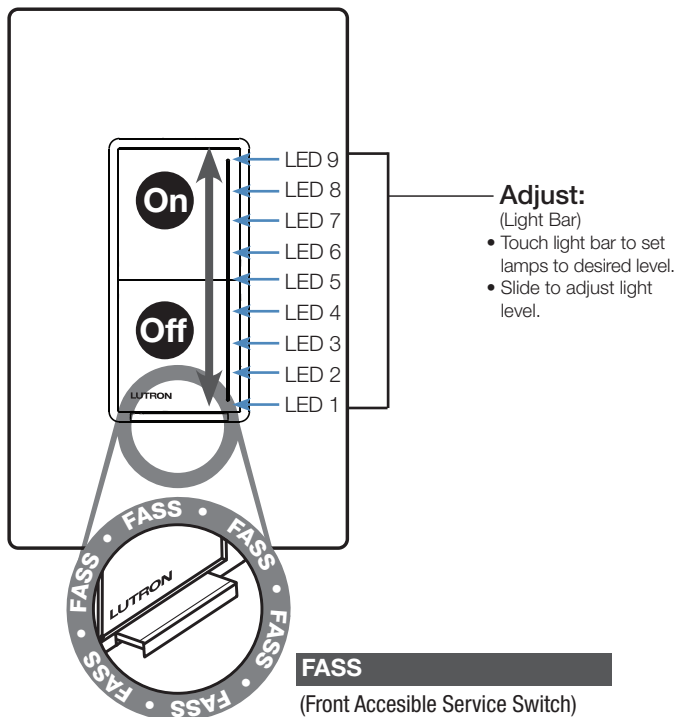

Glossary:	2
High-End Trim: Adjust the maximum light level of the load.	3
Low-End Trim: Adjust the minimum light level of the load.	4
Phase Select Mode (PRO-N only): Select to operate in forward- or reverse-phase dimming	5
Preset Light Level: Change the behavior of the device when the ON button is pressed from the OFF state to ON.	7
Light Bar Brightness: Select between high, medium, and low brightness of the control's light bar.	10
Light Level Indicator/Locator Light: Select between ON and OFF for the light bar when not interacting with the control.	12
Restore Factory Default Settings: Return the control to its original settings.	14
System Features:	14

Default Settings

Feature	Default
High-end trim	Highest level of trim range
Low-end trim	Middle level of trim range
Light level indicator/Locator light	ON/ON
Light bar brightness	Medium brightness
Preset light level	Tapping the ON button always sets the lights to full (locked preset at high-end)

Glossary

Change Feature Mode	Allows the user to modify the selected feature.
Default Setting	The way the feature operates when the control is first used.
Factory Default	The way all the features operate when the control is first used.
FASS	Tab at the bottom of the control, required to be pulled out for light bulb(s) replacement and changing advanced features; also known as <i>Air Gap</i> .
Flashing Quickly	Light bar on the dimmer is flashing ~8 times per second. This indicates the user is ready to change the selected feature.
Flashing Slowly	Light bar on the dimmer is flashing ~4 times per second. This indicates the user is ready to select the feature they would like to change.
High-End Trim	The highest achievable light level to which the control can be adjusted
Light Bar	The bar on the right side of the Sunnata dimmer paddle. See the diagram below.
Light Level Indicator	The light bar is illuminated to display the current load level when the load is on and the control has not been touched for about 2 seconds.
Load	The light bulb(s) that the control is controlling.
Locator Light	The entire light bar is faintly illuminated when the load is OFF.
Locked Preset	A programmable light level setting to which the control will turn on after tapping the ON button once.
Low-End Trim	The lowest achievable light level to which the control can be adjusted.
Normal Operation	Standard use of control (ON/OFF, touch); indicator lights will not be flashing.
Phase Select Mode	Allows for selection of forward- or reverse-phase dimming. The Phase Selectable dimmer default powers up in reverse-phase (PRO-N only).
Press and Hold	Sustained activation of the ON/OFF button for a specified period of time.
Slide	Lightly make contact with the control and move finger up or down without depressing any buttons.
Tap	Momentary activation of the ON/OFF button. Less than 1 second.
Touch	Lightly make contact with the control but do not depress any buttons.
Unlocked Preset	A light level setting that allows the control to turn ON to the last dimmed setting when tapping the ON button once. The control stores the light level setting after remaining there for one second. When in the load is off, a single LED will glow brighter than the rest to indicate the saved level.

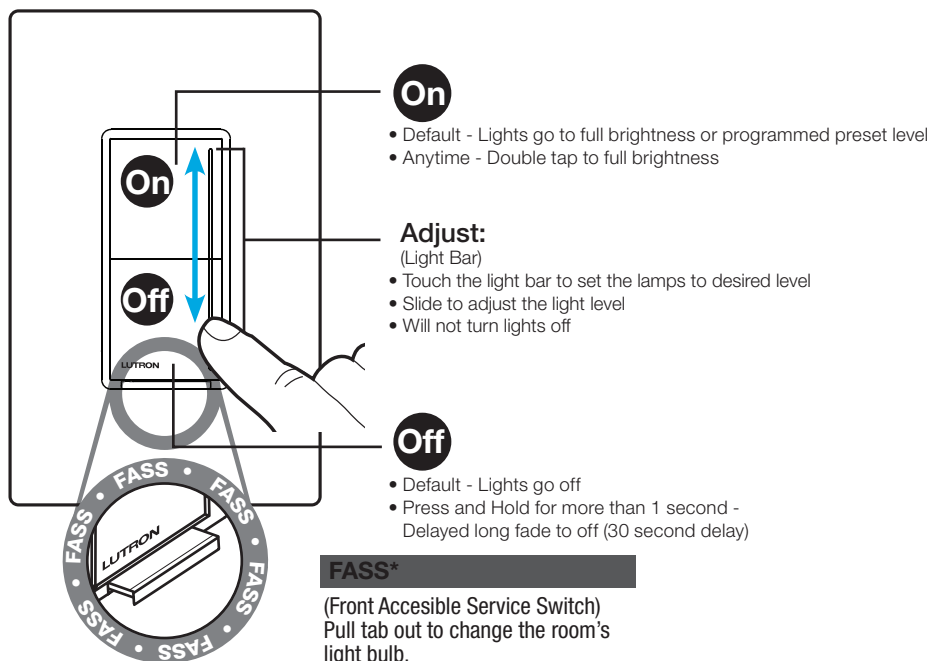

High-End Trim Shortcut

This feature allows the user to determine the maximum light level and adjust the settings accordingly. It is typically used to avoid undesirable lamp behavior near high-end or to reduce power consumption.

Default Setting: Highest level of trim range.

1. To enter **High-end Trim**, **touch** the top of the light bar continually **for about 6 seconds**. (DO NOT depress the **On** button.) The device will go to high-end and the light bar will begin **flashing slowly** (~4 times/second).

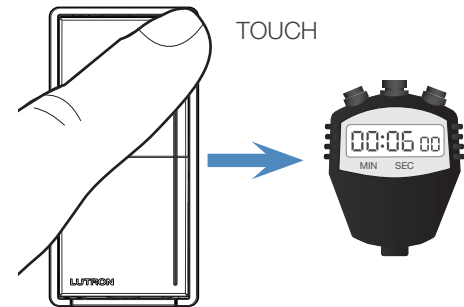

2. Remove your finger and the light bar will begin to **flash quickly** (~8 times/second) indicating the current high-end trim level. **Note:** The control will automatically exit high-end trim mode **after 1 minute** of inactivity.

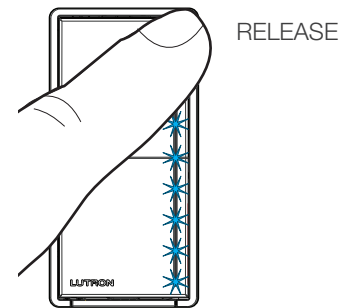

3. **Slide** your finger up or down the light bar to set the maximum light level (high-end). The trim setting follows your finger as it is adjusted.

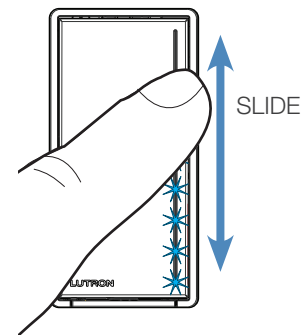

4. Once the maximum light level is acceptable, **Tap** the **Off** button to confirm your setting and exit into **Normal Operation**. **Note:** If at any time you are not happy with the settings you have achieved, you may [Restore Factory Default Settings](#). See page 14 for details.

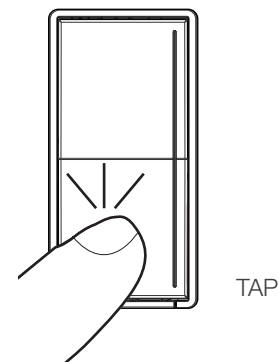

Low-End Trim Shortcut

This feature minimizes LED bulb flickering and strobing¹ when the dimmer is at the minimum light level. This feature can also be used to set a personal preference.

Default Setting: Middle level of trim range.

1. To enter **Low-end Trim**, **touch** the middle of the light bar continually **for about 6 seconds**. (DO NOT depress the **On** or **Off** button.) The device will go to low-end and the light bar will begin **flashing slowly** (~4 times/second).

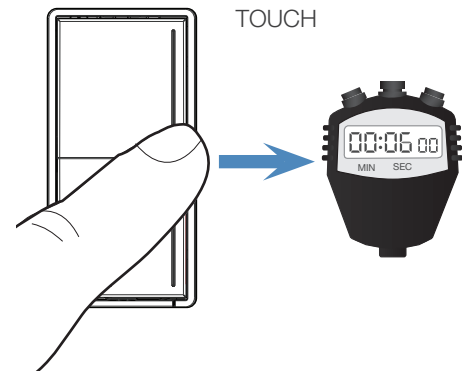

2. Remove your finger and the light bar will begin to **flash quickly** (~8 times/second) indicating the current low-end trim level. **Note:** The control will automatically exit low-end trim mode **after 1 minute** of inactivity.

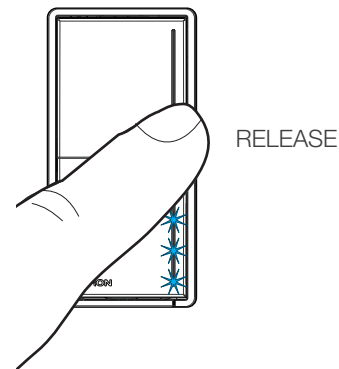

3. **Slide** your finger up or down the light bar to set the minimum light level (low-end). The trim setting follows your finger as it is adjusted.

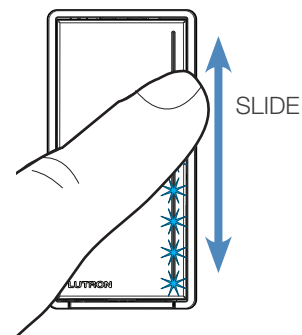

4. Once the minimum light level is acceptable, **Tap** the **Off** button to confirm your setting and exit into **Normal Operation**. **Note:** If at any time you are not happy with the settings you have achieved, you may [Restore Factory Default Settings](#). See page 14 for details.

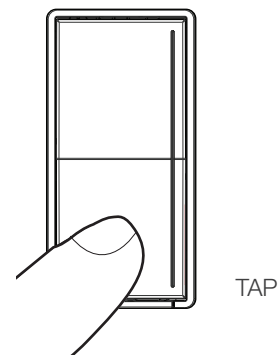

¹ Occurs when low-end trim is set too low for a given bulb's design capabilities, which can shorten lamp life.

Phase-Select Mode (PRO-N only)

1. **Pull** the Front Accessible Service Switch (**FASS**) out to the open position.

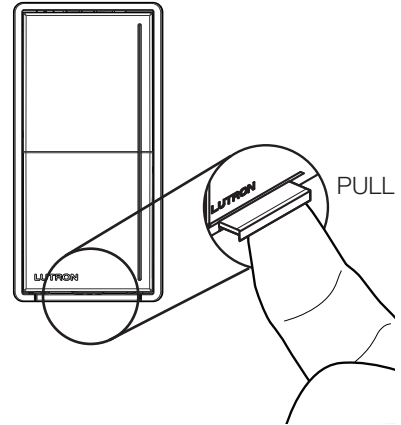

2. **Press and hold** the **On** button. (Press the left side of the button to not mistakenly affect the light bar.)

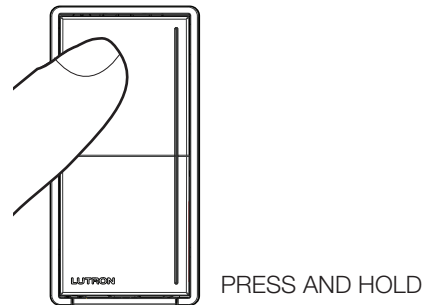

3. While continuing to **hold** the **On** button, **push** the Front Accessible Service Switch (**FASS**) in to the closed position. Continue to **hold** the **On** button **for approximately 6 seconds** until LED 1 and LED 9 start flashing.

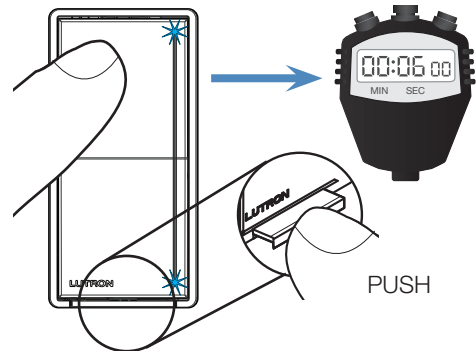

(continued on next page . . .)

Phase-Select Mode (PRO-N only) *(continued)*

4. **Release** the **On** button and **LED 1** or **LED 9** will continue to **flash slowly** (~4 times/second) to indicate current phase mode.

- LED 9 - Forward-phase
- LED 1 - Reverse-phase (**default**)

Touch the light bar to select the desired phase.

Note: The control will automatically exit low-end trim mode after 1 minute of inactivity.

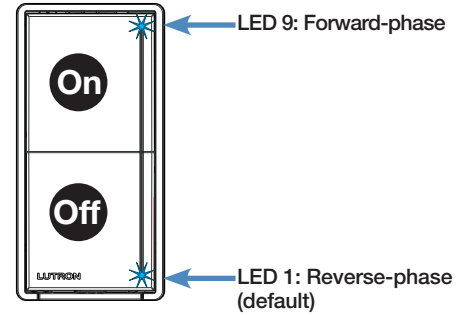
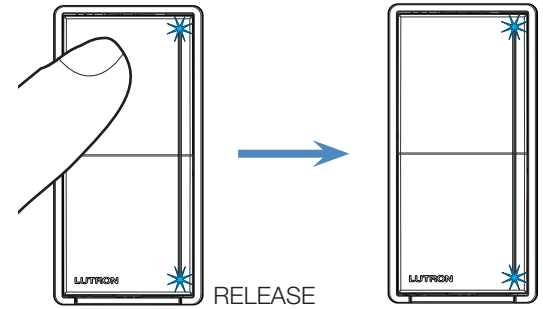

Exit Phase-Select Mode

5. **Press and hold** the **On** button for approximately 6 seconds to save and exit.

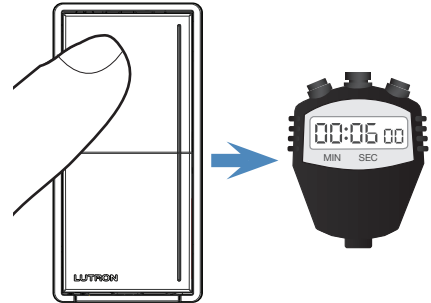

Preset Light Level

Change the behavior of the device when the **On** button is pressed from the **Off** state.

- **Unlocked Preset (Last Level Preset)** indicates that the device will come **On** to its last **On** level prior to turning **Off**. This level is indicated by an LED that glows brighter in the locator light state.
- **Locked Preset** indicates that the device will come **On** to a user specified level.

Default Setting: Tapping the **On button always sets the lights to full (Locked Preset at High-end).**

1. **Pull** the Front Accessible Service Switch (**FASS**) out to the open position.

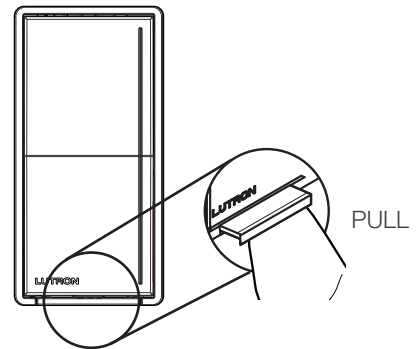

2. **Press and hold** the **Off** button. (Press the left side of the button to not mistakenly affect the light bar.)

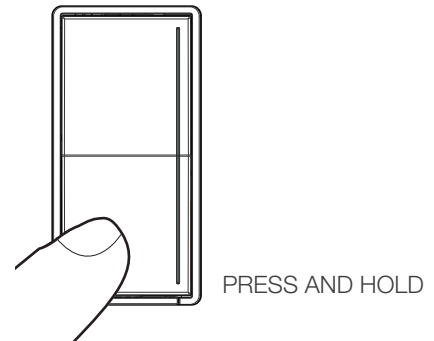

(continued on next page . . .)

Preset Light Level *(continued)*

3. While continuing to **hold** the **Off** button, **push** the Front Accessible Service Switch (**FASS**) in to the closed position. Continue to **hold** the **Off** button for **approximately 6 seconds**. The light bar will begin to **flash slowly** (~4 times/second).

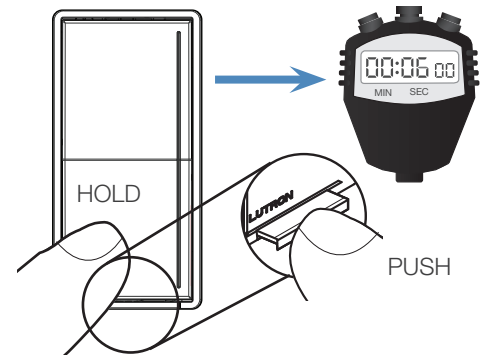

4. **Release** the **Off** button and **LED 1** will continue to **flash slowly** (~4 times/second).
Note: The control will automatically **exit this menu after 1 minute** of inactivity.

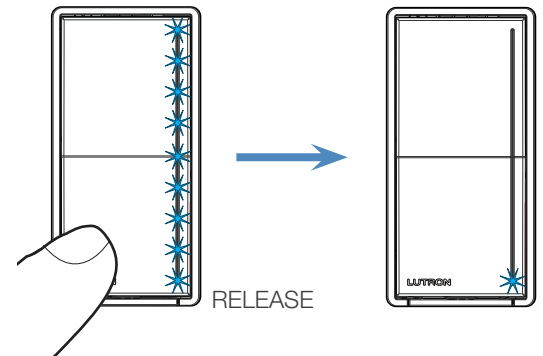

5. While LED 1 is **flashing slowly** (~4 times/second) **tap** the **Off** button. Some LEDs will be flashing quickly to indicate the current Preset setting.

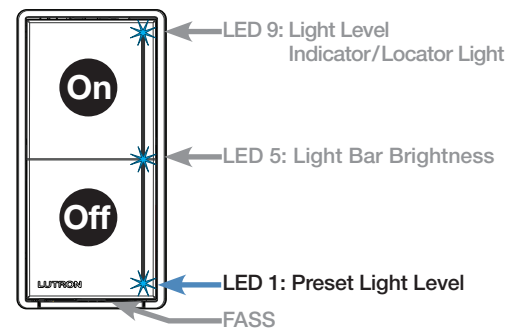

(continued on next page . . .)

Preset Light Level *(continued)*

Choose either . . .

6. a. Unlocked Preset

Lights turn on to the level they were at the last time they were turned off.

Touch and hold the middle of the light bar for **6 seconds** until the LEDs begin scrolling.

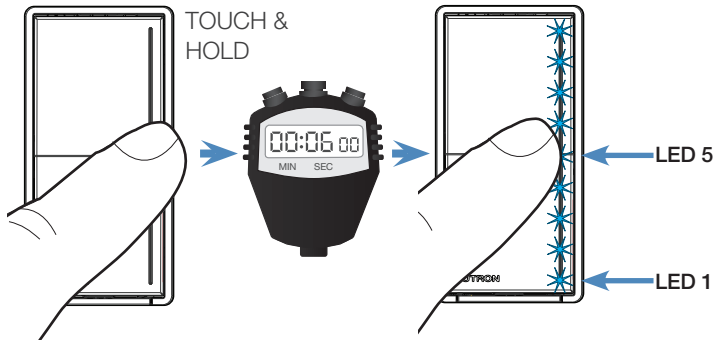

OR

b. Locked Preset

Lights turn on to this specified level no matter what level they were at the last time they were turned off.

Touch any part of the light bar to select a preset to lock. The light bar will be **flashing quickly** (~8 times/second) to indicate the protected preset light level.

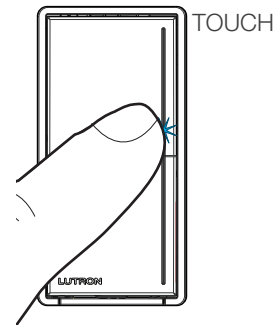

7. Tap the **Off** button to confirm and save your setting.

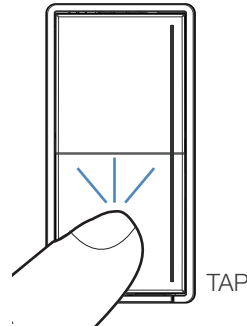

8. Press and hold the **Off** button for approximately 6 seconds to go back into Normal Operation.

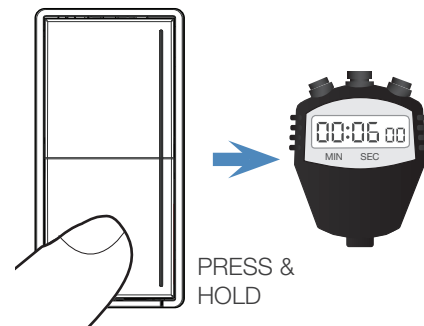

Light Bar Brightness Mode

Adjust the brightness of the LEDs on the light bar in the Active, Light Level Indicator, and Locator Light states. Select between high-, medium-, and low-brightness of the control's light bar.

Default Setting: Medium brightness

1. **Pull** the Front Accessible Service Switch (**FASS**) out to the open position.

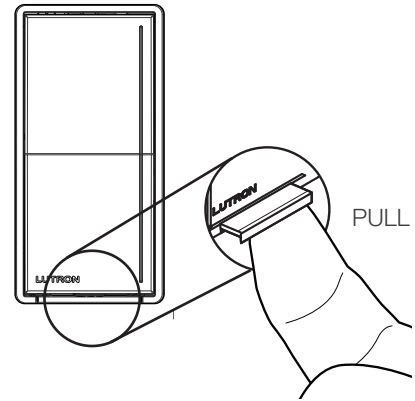

2. **Press and hold** the **Off** button. (Press the left side of the button to not mistakenly affect the light bar.)

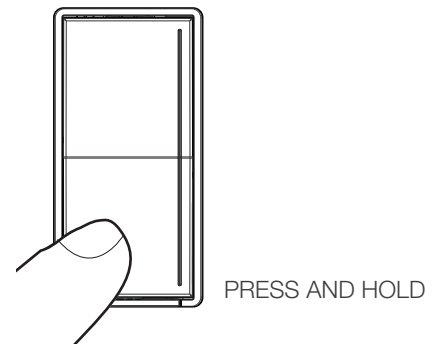

3. While continuing to **hold** the **Off** button, **push** the Front Accessible Service Switch (**FASS**) in to the closed position. Continue to **hold** the **Off** button **for approximately 6 seconds**. The light bar will begin to **flash slowly** (~4 times/second).

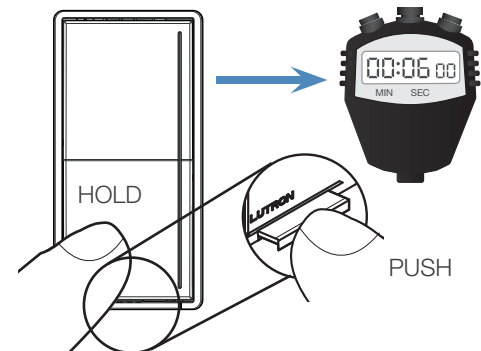

4. **Release** the **Off** button and **LED 1** will continue to **flash slowly** (~4 times/second).
Note: The control will automatically **exit this menu after 1 minute** of inactivity.

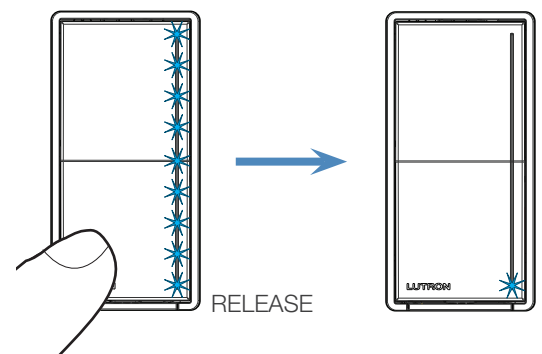

(continued on next page . . .)

Light Bar Brightness Mode *(continued)*

- Select the **Light Bar Brightness** menu by **touching** LED 5 and tapping the **Off** button. An LED will be flashing quickly to indicate the current Light Bar Brightness setting.

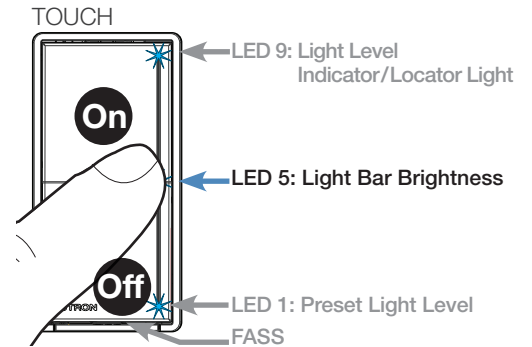

- Touch** the light bar in the area of the LED corresponding to your selection.

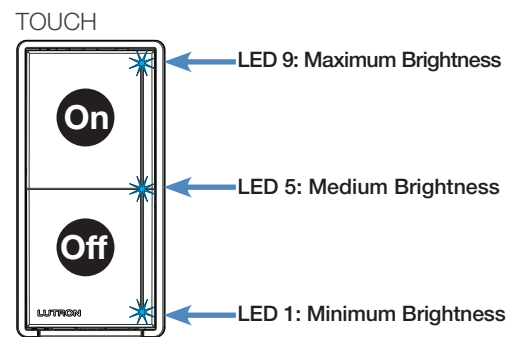

- Tap** the **Off** button to confirm and save your settings.

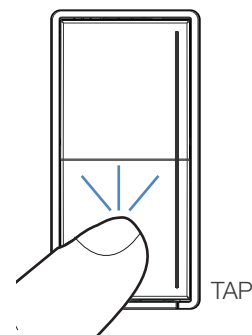

- Press and hold** the **Off** button for approximately 6 seconds to go back into **Normal Operation**.

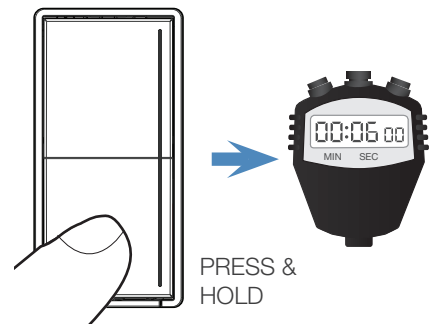

Light Level Indicator/Locator Light Mode

This feature can enable or disable the Light Level Indicator and the Locator Light.

- **Light Level Indicator** - Light bar behavior when load is ON and it has not been touched for about 2 seconds.
- **Locator Light** - Light bar behavior when load is OFF.

Default Setting: ON/ON

1. **Pull** the Front Accessible Service Switch (**FASS**) out to the open position.

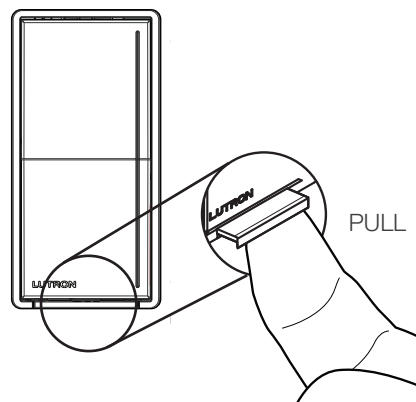

2. **Press and hold** the **Off** button. (Press the left side of the button to not mistakenly affect the light bar.)

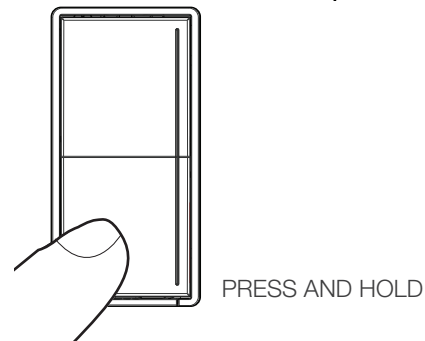

3. While continuing to **hold** the **Off** button, **push** the Front Accessible Service Switch (**FASS**) in to the closed position. Continue to **hold** the **Off** button for approximately 6 seconds. The light bar will begin to **flash slowly** (~4 times/second).

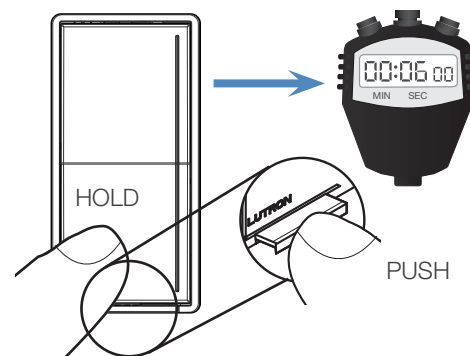

4. **Release** the **Off** button and **LED 1** will continue to **flash slowly** (~4 times/second).

Note: The control will automatically **exit this menu after 1 minute** of inactivity.

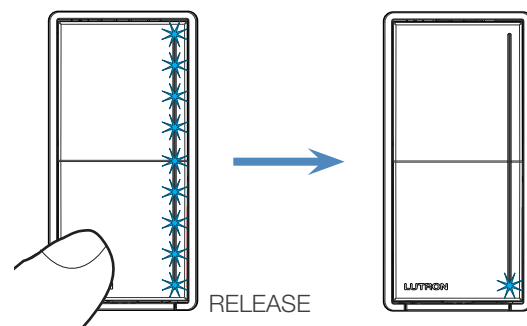

(continued on next page . . .)

Light Level Indicator/Locator Light Mode *(continued)*

5. Select the **Light Level Indicator/Locator Light** feature by touching LED 9 and tapping the **Off** button. An LED will begin flashing quickly to indicate the current Light Level Indicator setting.

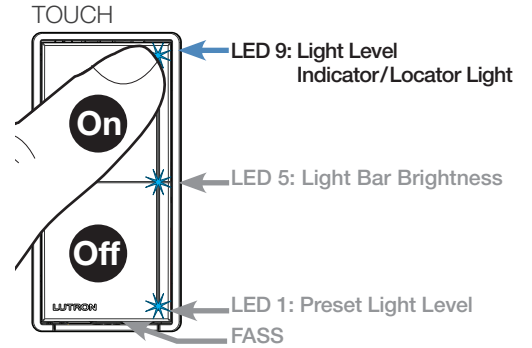

6. **Touch** the light bar in the area of the LED corresponding to your selection.

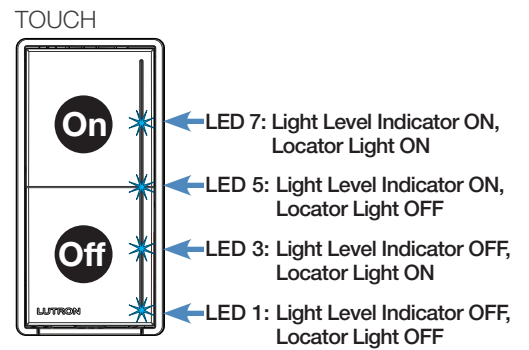

7. **Tap** the **Off** button to confirm and save your settings.

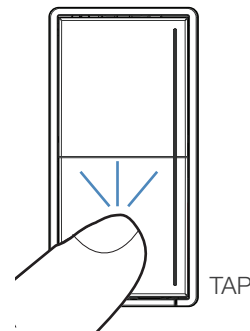

8. **Press and hold** the **Off** button for approximately 6 seconds go back into **Normal Operation**.

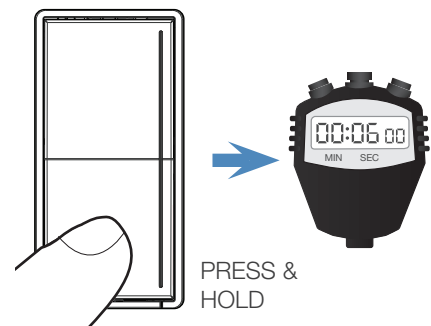

Restore Factory Default Settings

The dimmer can be returned to its original factory settings. This allows the customer a risk-free experience to try multiple settings.

Default Settings

Feature	Default
High-end trim	Highest level of trim range
Low-end trim	Middle level of trim range
Light level indicator/Locator light	ON/ON
Light bar brightness	Medium brightness
Preset light level	Tapping the On button always sets the lights to full (locked preset at high-end)

1. **Triple tap** the **Off** button **rapidly, holding** on the last press.
2. **Continue holding** until the light bar and the lighting load begin to **raise from low to high** in about 3 seconds.
3. Immediately **triple tap** the **Off** button again and **release**.
4. The light bar and lighting load will begin to raise from low to high 3 times, the middle of the light bar flashes, the lights turn off and then turn back on to high-end.

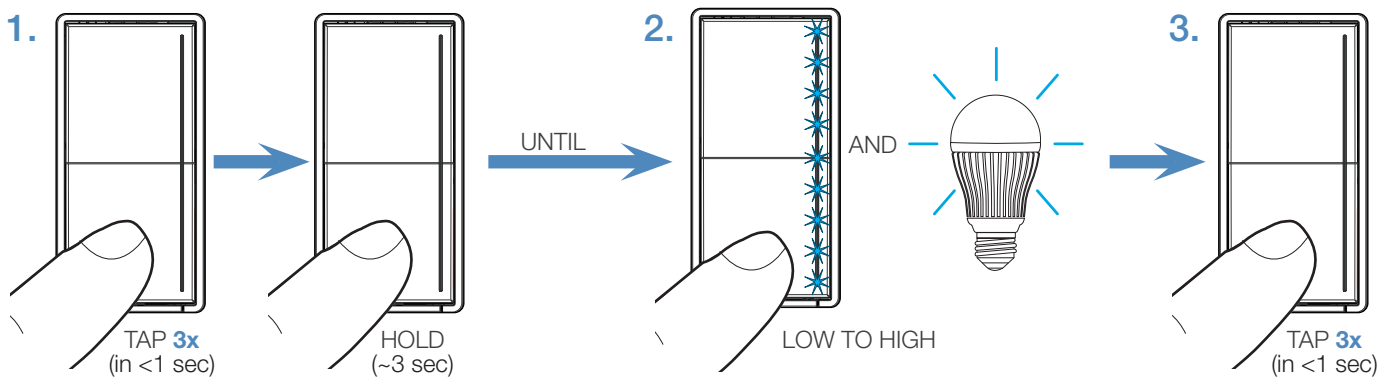

System Features (HRST- and RRST- Models Only)

Note: If setting up as part of a system, phase settings and low-end trim levels made on the dimmer will be over-written by the system software.

RRST-PRO-N - For use in a RadioRA 3 system, please refer to the Getting Started Guide: www.lutron.com/RA3support

Some dimmer behavior features can only be adjusted through the Lutron Designer software.

1. **Fade ON/OFF rate:** The rate at which the load turns ON or OFF from its previous state.
2. **Delayed Long Fade-to-Off (DLFTO) Time:** Allows for control over how quickly/slowly the load begins the start of the dimming sequence. This setting delays the time between when the **Off** button is pressed (normal operation) and when the lights actually begin the fade-to-off process.

Lutron, FASS, MyLevel, RadioRA 3, and Sunnata are trademarks or registered trademarks of Lutron Electronics Co., Inc. in the US and/or other countries.

Lutron Contact Numbers

WORLD HEADQUARTERS

USA

Lutron Electronics Co., Inc.
7200 Suter Road
Coopersburg, PA 18036-1299

TEL: +1.610.282.3800

FAX: +1.610.282.1243

support@lutron.com

www.lutron.com/support

North & South America

Customer Assistance

USA, Canada, Caribbean:

1.844.LUTRON1 (1.844.588.7661)

Mexico:

+1.888.235.2910

Central/South America:

+1.610.282.6701

UK AND EUROPE:

Lutron EA Limited

125 Finsbury Pavement
4th floor, London EC2A 1NQ
United Kingdom

TEL: +44.(0)20.7702.0657

FAX: +44.(0)20.7480.6899

FREEPHONE (UK): 0800.282.107

Technical Support: +44.(0)20.7680.4481

lutronlondon@lutron.com

ASIA:

Lutron GL Ltd.

390 Havelock Road
#07-04 King's Centre
Singapore 169662

TEL: +65.6220.4666

FAX: +65.6220.4333

Technical Support: 800.120.4491

lutronsea@lutron.com

Asia Technical Hotlines

Northern China: 10.800.712.1536

Southern China: 10.800.120.1536

Hong Kong: 800.901.849

Indonesia: 001.803.011.3994

Japan: +81.3.5575.8411

Macau: 0800.401

Taiwan: 00.801.137.737

Thailand: 001.800.120.665853

Other Countries: +65.6220.4666