



Low Voltage Mounting Brackets

New!

Single and 2-gang brackets for installations on existing construction. Designed to install **LOW VOLTAGE Class 2 ONLY**. Provides fast installation with a hole saw.

CATALOG NUMBER	UPC/DCI/NAED MFG #01 8997	DESCRIPTION/INSTALL METHOD	UNIT/STD PKG	DIM A	DIM B	DIM C
LV1RP	58179	Single-Gang/ 3.5" diam. hole saw	25	5.625	3.875	2.053
LV2RP	58183	2-Gang/ 4.5" diam. hole saw	10	5.250	5.375	2.135

PATENTS PENDING.



E253895 LR49636

FOR THE FASTEST, EASIEST INSTALLATIONS... LESS THAN A MINUTE!

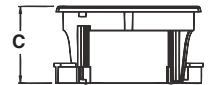
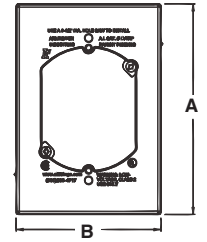

LV1RP



LV2RP

Features and Benefits

- Easiest and fastest installation of class 2 low voltage wiring devices
- Faster than our LV1 mounting bracket, LV1RP installs in less than a minute with a hole saw!
- Single-gang LV1RP installs with a 3.5" hole saw and 2-gang LV2RP installs with a 4.5" hole saw
- Paintable front surface (optional)
- Adjusts to fit 1/4" to 1-1/2" wall thicknesses
- Mounting wings hold bracket securely against wall when screws are tightened
- Finishes with any standard, mid-size, or maximum wall plate
- Easy to level – even after it's installed
- Allows for easy access to cables. Reach through the opening to pull cables from behind the wall.

Installation Instructions



For a video installation demonstration visit our website @ aifittings.com



1
Determine mounting bracket location. Cut opening with a hole saw; 3.5" for single-gang LV1RP, 4.5" for the 2-gang LV2RP.



2
Pull cables from behind the wall. (Easy access to cables is another reason to use Arlington's new low voltage mounting brackets!)



3
Insert mounting bracket into the opening. Rotate as necessary to level. Shown with single-gang LV1RP.

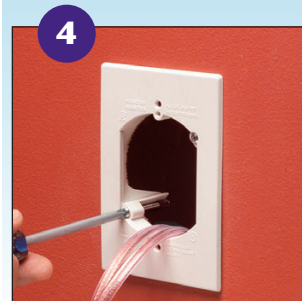

4
Tighten screws. Mounting wings hold mounting bracket securely against drywall – No wobble once it is installed!



5
If desired, paint front surface to match wall (photo 5a). Install low voltage device.



6
Finish with any single-gang wall plate. (Front surface shown unpainted.)